

A2000/B2000 Differential Pressure Gauge

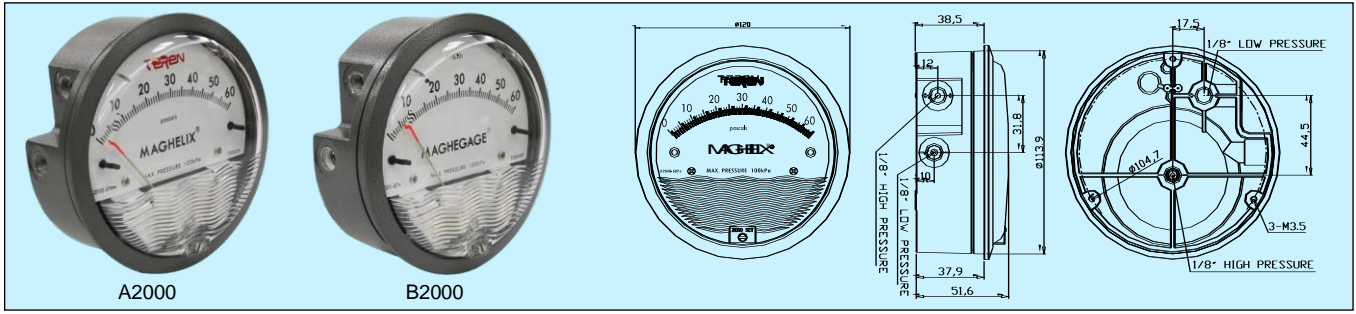

Applications & Features

- They can measure system pressures of fan, blower, filter resistance, furnace draft and orifice plates. And they can also measure pressures in various clean room, bio-safety cabinet, clean bench, industrial cleaner, medical respiratory equipment and air sampler, etc.
- 63 models available for different ranges and units for various applications
- With simple and frictionless movement, it quickly indicates air or gas pressure, either positive, negative or differential
- The design resists shock, vibration and over pressures
- Ultra-thin design: the flushed part is only 38.5mm, and the overall thickness is only 52.2mm
- Patented state of art wave shape decorative front cover
- Standard accuracy up to 2% and high accuracy up to 1%FS
- Optional mirrored scale overlay eliminates parallax reading error and corrosion resistant brushed 304 SS bezel
- A2000 (use trade mark MAGHELIX) has very fine parts and assembly procedures to ensure extraordinary accuracy, stable and reliable for long term application, and have a Test Report for multiple points. While B2000 (use trade mark MAGHEGAGE) have simplified assembly and testing procedures without the report

Specifications

Service: Air and non-combustible compatible gases
Housing: Die cast aluminum case and bezel, with PC cover
Protection: IP67
Accuracy: ±2%FS (±3% on 125Pa, ±4% on 60Pa) @21°C
Pressure Limits: -70 to 100 KPa
Size: 101.5mm (4") diameter dial face, 115.5 mm (4-9/16") dia. opening for flush mount
Temperature Limits: -7 to 60°C (20 to 140°F)
Connections: 1/8" NPT female high and low pressure taps, duplicated, one pair side and one pair back
Weight: 440g
Mounting method: Flush or surface in vertical position
Standard accessory: Model A-S10, including two 1/8"NPT pipe plugs, two 1/8" NPT to 3/16" rubber tubing adapters and three flush mounting adapters with screws
Other Accessories: sold separately, see details on Accessories
Approval: RoHS (A2000)

Models (For A2000, use B instead for B2000 series)

Model Number	Range Pa	Model Number	Range in wc
A2000-60Pa**	10-0-50	A2000-00N**	0.05-0-.2
A2000-60Pa**	0-60	A2000-00**	0-.25
A2000-125Pa*	0-125	A2000-0*	0-.50
A2000-250Pa	0-250	A2001	0-1.0
A2000-500Pa	0-500	A2002	0-2.0
A2000-750Pa	0-750	A2003	0-3.0
Zero Center Ranges Pa		A2004	0-4.0
A2300-60Pa**	30-0-30	A2005	0-5.0
A2300-120Pa*	60-0-60	A2006	0-6.0
A2300-250Pa	125-0-125	A2008	0-8.0
A2300-500Pa	250-0-250	A2010	0-10
Model Number		Range kPa	
A2000-1KPa	0-1	A2012	0-12
A2000-1.5KPa	0-1.5	A2015	0-15
A2000-2KPa	0-2	A2020	0-20
A2000-3KPa	0-3	A2025	0-25
A2000-4KPa	0-4	A2030	0-30
A2000-5KPa	0-5	A2040	0-40
Model Number		Range mm wc	
A2000-6MM**	0-6		
A2000-10MM*	0-10		
A2000-15MM*	0-15		
A2000-25MM	0-25		
A2000-30MM	0-30		
A2000-50MM	0-50		
A2000-80MM	0-80		
A2000-100MM	0-100		
Zero Center Ranges kPa		Zero Center Ranges in wc	
A2300-1KPa	.5-0-.5	A2300-00**	.125-0-.125
A2300-2KPa	1.0-0-1.0	A2300-0*	.25-0-.25
Model Number		Range cm wc	
A2000-6MM**	0-6		
A2000-10MM*	0-10		
A2000-15MM*	0-15		
A2000-25MM	0-25		
A2000-30MM	0-30		
A2000-50MM	0-50		
A2000-80MM	0-80		
A2000-100MM	0-100		
Zero Center Ranges mm wc		Zero Center Ranges cm wc	
A2300-6MM**	3-0-3	A2300-4CM	2-0-2
A2300-10MM*	5-0-5	A2300-10CM	5-0-5
A2300-20MM	10-0-10	A2300-20CM	10-0-10

**Accuracy 4%; *Accuracy 3%; Others accuracy 2%

Options:

1. **Mirrored Scale:** Eliminates parallax reading error, to order add suffix M
2. **Brushed 304 SS Bezel:** Corrosion resistant bezel, to order add suffix S
3. **High Accuracy Calibration(only for A2000):** Calibrated to accuracy 2%/1.5%/1% respectively, which are as twice as standard Maghelix gauges, with Mirrored Scale and Calibration Certificate, to order add suffix H

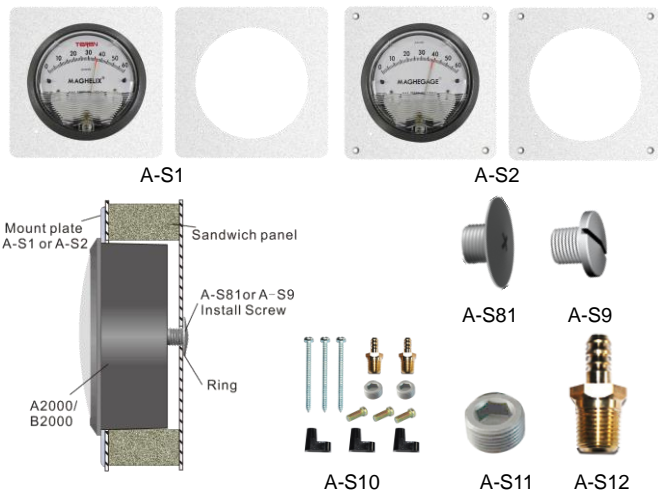

Attentions:

1. Before installing, please verify that the application range matches the gage range to prevent damage.
2. The working temperature of the gage should be less than 60 °C (140 °F). The gage was calibrated in vertical position, so it should be installed vertically to ensure the accuracy. Otherwise, it should be zeroed again or recalibrated.

Installations

1. Surface mount

(1) As shown in Figure 1 below, drill 3 equally 120° and 4.5 mm diameters mounting holes on the mounting panel, screw the 3 short mounting screws from the accessory into the 3 mounting holes on the bottom of the gage.

(2) As shown in Figure 2, take the 3 mounting adapters and 3 short screws from the accessory, fix the adapters on the bottom of the gage. Then take the 3 long screws and securely fix the gage on the mounting surface.

2. Flush (panel) mount

As shown in Figure 3 below, prepare a 115.5 mm (4-9/16") dia. opening in the install panel, put the gage in. Take the 3 mounting adapters and 3 short screws from the accessory, fix the adapters on the bottom of the gage, then take the 3 long screws and lock the gage on the panel.

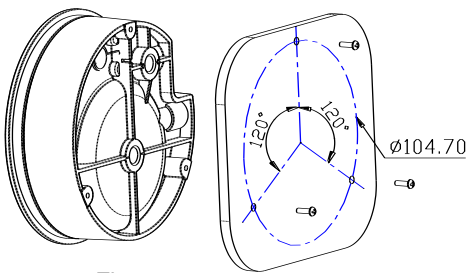

Figure 1

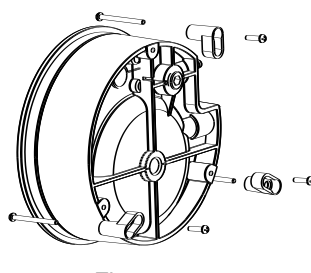

Figure 2

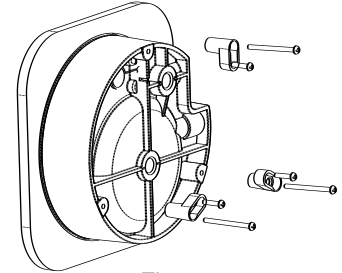

Figure 3

3. Flush (sandwich panel) mount

As shown in Figure 4 below, prepare a 115.5 mm (4-9/16") dia. opening in one side of sandwich panel, fit the A-S1/S2 panel on the gage and put into the sandwich panel. Then screw the A-S81 into the pressure port on the bottom of the gage from the other side of sandwich panel. The accessories A-S1/S2 and A-S81 need to be ordered separately.

4. Other installation method, as shown in Figure 5 below, screw the A-S9 into the pressure port on the bottom of the gage. Accessory A-S9 needs to be ordered separately.

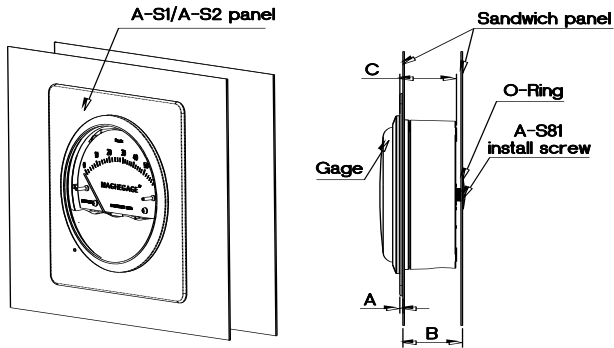

Figure 4

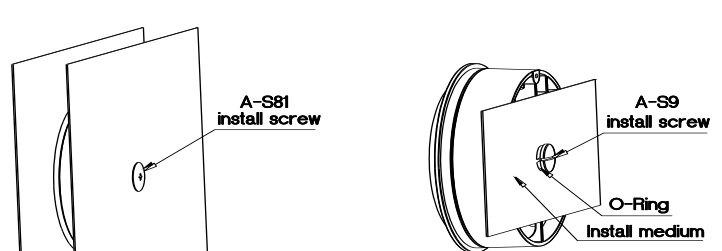

Figure 5

5. Re-Zero

Once installed, the gage needs to be re-zeroed. Use a suitable slotted screwdriver to turn the zero screw at the bottom on the transparent cover to make the pointer indicating the zero position of the dial. Be sure that the operation should be made when the two pressure ports open to air at the same time.

6. Pressure connection

Use the standard accessories to properly connect one of the two "+" and "-" pressure ports as needed. The two pairs of pressure ports are on side and back. Finally plug the other pair of unused ports with the pipe plugs from the accessories.

Warranty

It has limited warranty for eighteen (18) months after the production date.

Shenzhen TEREN Control Technology Co. Ltd.

Add: 3F, 2nd Industrial Zone, Nankeng, Longgang District, Shenzhen, Guangdong, P.R. CHINA

Tel: 0755-23935155 Fax: 0755-23935156

web: www.teren.com.cn



TEREN website



Alibaba shop